



서울대학교
SEOUL NATIONAL UNIVERSITY

ASIAN ECONOMIC DEVELOPMENT CONFERENCE 2024

13–14 July 2024 | Seoul, Republic of Korea

As of 4 July 2024

Contents

About AEDC	2
About the Co-Organizers	3
Asian Development Review	4
Keynote Speakers	5
Conference Program	7
Conference Venue	17
Presenters and Discussants	20
Internet Access	56
Transportation Guide	57

About AEDC

The Asian Economic Development Conference (AEDC) is an annual research conference organized by the Asian Development Bank (ADB), Asian Development Bank Institute (ADBI), and an esteemed university cohost from Asia. The third AEDC will be co-hosted by the ADB, ADBI, and Seoul National University (SNU) on 13–14 July 2024 in SNU campus.

The objective of the AEDC is to promote high-quality, frontline research on major economic development issues relevant to developing Asia and the Pacific and to foster knowledge sharing among social scientists, development practitioners, and policymakers. The conference features presentations of unpublished empirical analyses, survey articles, economic modelling, and policy-oriented research on a range of topics on development economics, such as the following:

- **Agriculture and Rural Development:** food security, productivity, and agricultural markets
- **Health and Education:** access to health care and education, aging, and demographic challenges
- **Labor:** skills, future of work, job security, job quality, and labor productivity
- **Gender:** gaps in income and opportunities, and gender empowerment
- **Poverty, Inequality, and Welfare:** income gaps, income shocks, role of social safety nets, MSMEs, intra-household dynamics, and social development
- **Climate Change and Environment:** climate change mitigation and adaptation, natural capital, sustainable development, net-zero transition, carbon pricing, energy transition, and natural disasters
- **Macroeconomics and Finance:** economic growth, capital market, sustainable finance, inflation, macro and financial stability, fiscal and monetary policy
- **Regional Cooperation and Economic Integration:** trade, economic and financial integration, global value chains, migration, capital flows, cross-border investment
- **Infrastructure:** energy, transport, water, urban development, and quality infrastructure
- **Digital Economy and Innovation:** digital transformation, closing digital divides, technology and innovation, entrepreneurship, digital currencies and assets, data science, and big data
- **Domestic Resource Mobilization and Governance:** public finance, debt sustainability, public management, bureaucracy, corruption, and taxation.

AEDC 2024 Advisory Board

Albert F. Park (ADB)

Joseph E. Zveglic, Jr. (ADB)

John Gibson (University of Waikato)

Donghyun Park (ADB)

Shu Tian (ADB)

Gemma Estrada (ADB)

Tetsushi Sonobe (ADBI)

Peter Morgan (ADBI)

Daniel Suryadarma
(ADBI)

Bonggeun Kim (SNU)

Keun Lee (SNU)

Youjin Hahn (Yonsei
University)

About the Co-Organizers

Asian Development Bank

The Asian Development Bank (ADB) is committed to achieving a prosperous, inclusive, resilient, and sustainable Asia and the Pacific, while sustaining its efforts to eradicate extreme poverty. Established in 1966, it is owned by 68 members —49 from the region. Its main instruments for helping its developing member countries are policy dialogue, loans, equity investments, guarantees, grants, and technical assistance.

The Economic Research and Development Impact Department of ADB undertakes policy research to generate knowledge on key development issues of critical importance to the region; advise on strategic issues that contribute to ADB's performance; and support ADB's lending operations, policy dialogue with DMCs, and capacity building activities.

Asian Development Bank Institute

The Asian Development Bank Institute (ADBI) is the Tokyo-based think tank of the Asian Development Bank. ADBI provides demand-driven policy research, capacity building and training, and outreach to help developing countries in Asia and the Pacific practically address sustainability challenges, accelerate socioeconomic change, and realize more robust, inclusive, and sustainable growth.

Seoul National University Institute of Economic Research

The Seoul National University Institute of Economic Research has been engaged in continuous theoretical research and policy development on economic issues since February 1961, when its predecessor, the Korea Economic Research Institute, was established to contribute to the stability and development of the Korean economy.

The institute has been conducting various academic research projects according to each researcher's major field of study, and it also continues to conduct joint research projects with other research institutes in Korea and abroad by holding seminars, symposiums, and research presentations. In addition, the institute publishes 'Economic Monographs' in Korean and 'Seoul Journal of Economics' in English, which aim to be places for policy discussions on the Korean economy.

Asian Development Review

The Asian Development Review (ADR) is the journal of the Asian Development Bank (ADB) and the Asian Development Bank Institute (ADBI). It publishes research on development issues relevant to the countries of the Asia and Pacific region, specifically ADB's member countries. The ADR publishes empirical papers, survey articles, historical analyses, and policy-oriented work. It bridges theoretical work and rigorous empirical studies that advance the understanding of Asia's development, and it is open to discussions of alternative perspectives on all aspects of development, including globalization, inequality, structural transformation, and poverty. The ADR aims to disseminate the best research, with contributions from scholars in all fields, with the objective of providing the knowledge necessary for designing, implementing, and sustaining effective development policies. Its intended audience comprises a worldwide readership of economists and other social scientists.

Authors of selected papers from the AEDC conference program are invited to present their papers in a Mini Symposium of the ADR at AEDC and submit their work for publication in the [Asian Development Review \(ADR\)](#).

ADR Editorial Board

Editor-in-Chief

John Gibson (*University of Waikato*)

Managing Editor

Donghyun Park (*Asian Development Bank*)

Associate Editors

Yi Jiang (*Asian Development Bank*)

Yothin Jinjarak (*Asian Development Bank*)

Shu Tian (*Asian Development Bank*)

Sujata Visaria (*Hong Kong University of Science and Technology & City, University of London*)

Editorial Board

Kym Anderson (*University of Adelaide*)

Prema-Chandra Athukorala (*Australian National University*)

John Beirne (*Asian Development Bank*)

Neil Foster-McGregor (*Asian Development Bank*)

Shin-Ichi Fukuda (*The University of Tokyo*)

Rana Hasan (*Asian Development Bank*)

Sung Jin Kang (*Korea University*)

Xin Meng (*Australian National University*)

Ahmed Mushfiq Mobarak (*Yale University*)

Albert Park (*Asian Development Bank*)

Dil Rahut (*Asian Development Bank Institute*)

Krislert Samphantharak (*University of California, San Diego*)

Kunal Sen (*UNU-WIDER and The University of Manchester*)

Kwanho Shin (*Korea University*)

Tetsushi Sonobe (*Asian Development Bank Institute*)

Daniel Suryadarma (*Asian Development Bank Institute*)

Joseph Ernest Zveglich, Jr. (*Asian Development Bank*)

Aya Suzuki (*The University of Tokyo*)

Keynote Speakers

Professor Lisa Cameron



Lisa Cameron is the Riady Chair of Asian Economics and Business and a Professorial Research Fellow at the Melbourne Institute of Applied Economic and Social Research, University of Melbourne. She is an empirical micro-economist whose research incorporates the techniques of experimental and behavioral economics to better understand human decision-making. Much of her research focuses on policy evaluation—understanding the impacts and behavioral implications of public policy, with a focus on social and economic issues. She is particularly interested in the welfare of disadvantaged and marginalized groups and the socio-economic determinants of health. Much of her research to date has focused on developing countries, particularly Indonesia and the People’s Republic of China, and she has extensive experience collaborating with agencies such as the World Bank and the

Australian Aid Program. Lisa received her PhD from Princeton University in 1996. She was elected a Fellow of the Australian Academy of Social Sciences in 2014 and appointed a Fellow of the International Economic Association in 2022.

Professor Keun Lee



Keun Lee is Distinguished Professor of Seoul National University (economics), a Fellow of the CIFAR (Canada), and the chairman of the Center for Economic Catch-up. He is also an editor of Research Policy, and associate editor of Industrial and Corporate Change. He is the winner of the 2014 Schumpeter Prize for his monograph on Schumpeterian Analysis of Economic Catch-up (2013 Cambridge Univ. Press), and also the 2019 Kapp Prize by EAEPE. He is also awarded the title of EBES Fellow of the Year 2023 by the EBES. He writes regularly for Project Syndicate. Previously, He served as the Vice-chairman of the National Economic Advisory Council for the chair and President of Korea, as the President of the

International Schumpeter Society (2016–18), a member of the Committee for Development Policy of UN (2013–18), a GFC member of the World Economic Forum (2016–19). He obtained his Ph.D. in economics from the University of California, Berkeley. His total citations received is about 14,100 with H-index of 55 and I-10 index of 154 (Google Scholar).

Professor Justin Yifu Lin



Justin Yifu Lin is Dean of Institute of New Structural Economics, Dean of Institute of South-South Cooperation and Development and Professor and Honorary Dean of National School of Development at Peking University. He was the Senior Vice President and Chief Economist of the World Bank, 2008-2012. Prior to this, Mr. Lin served for 15 years as Founding Director and Professor of the China Centre for Economic Research (CCER) at Peking University. He is a member of the Standing Committee, Chinese People's Political Consultation Conference. He is the author of more than 20 books including Justin Yifu Lin on China's Economy, *Beating the Odds: Jump-starting Developing Countries*; *Going Beyond Aid: Development Cooperation for Structural Transformation*, *the Quest for Prosperity: How Developing Economies Can Take Off*, *New Structural Economics: A Framework for Rethinking Development and Policy*, *Against the Consensus: Reflections on the Great Recession*, and *Demystifying the Chinese Economy*. He is a Corresponding Fellow of the British Academy and a Fellow of the Academy of Sciences for Developing World.

Conference Program

(as of 4 July 2024)

13 July 2024, Saturday

8:30 am-9:00 am	Registration (Woosuk Economic Hall, Building 223)				
9:00 am-9:15 am	Moderator	Joseph E. Zveglic Jr., Deputy Chief Economist, Asian Development Bank			
	Welcome Remarks	Bonggeun Kim, Head of Economics Department, Seoul National University			
	Opening Remarks	Tetsushi Sonobe, Dean and Chief Executive Officer, Asian Development Bank Institute			
9:15 am-9:45 am	Keynote Speech	Lisa Cameron, Riady Chair of Asian Economics and Business and Professorial Research Fellow, University of Melbourne			
	(Room 107, Woosuk Economic Hall)				
9:45 am-10:00 am	Coffee break (Woosuk Economic Hall, 1F)				
10:00 am-12:00 noon	Sessions 1A-1F				
	Parallel Session 1A Climate Change and Environment I (Room 107, Woosuk Economic Hall)	1. Fossil Fuel Subsidies and GHG Emissions: Firm-level Empirical Evidence from Developing Asia	2. Are Natural Disasters Disastrous for Learning? Evidence from Seven Asian Countries	3. Lead Exposure from Toxic Sites and Cognitive Skills: Evidence from Indonesia	4. Air Pollution Policy and Labor Productivity - Economic Benefits from Demand for Clean Air
	Parallel Session 1B Gender I (Room 109, Woosuk Economic Hall)	1. Unintended Effects of Delayed Marriage on Women's Attitudes Toward Intimate Partner Violence: Evidence from Cambodia	2. Women's Labor Supply, Decision Making Power, and Cultural Norms: Evidence from Indonesia's Domestic Violence Law	3. Training Intensity and Female Labour Market Outcomes: Evidence from Indonesia during COVID-19 Pandemic	4. Sex Imbalance and Female Resilience: Insights from China's College Entrance Examinations

<p><u>Parallel Session 1C</u> Labor I</p>	<p>1. Prevalent Informality and Labour Allocation</p>	<p>2. Child Labour in India: Long Term Trends and Measurement Issues</p>	<p>3. Meat or Poison? Minimum Wages for Chinese Firms and Workers</p>	
<p>(Room 207, Woosuk Economic Hall)</p>				
<p><u>Parallel Session 1D</u> Macroeconomics and Finance I</p>	<p>1. Estimating the Impact of BSP Policy Adjustments on Bank Lending: A Panel VAR Model Approach</p>	<p>2. Disaggregated Inflation Dynamics in Thailand: Which Shocks Matter?</p>	<p>3. Inflation Convergence Dynamics in India: An Analysis of Headline and Core Inflation</p>	<p>4. Inflation: The Macroeconomic Consequence of Terror Activity in Pakistan</p>
<p>(Room 208, Woosuk Economic Hall)</p>				
<p><u>Parallel Session 1E</u> Digital Economy and Innovation</p>	<p>1. Identifying Growth Effect of Internet Penetration</p>	<p>2. Investigating the Key Factors Affecting Innovative Capacity in Asian Countries</p>	<p>3. Digital Money Demand and Monetary Policy</p>	<p>4. Inventor Mobility and Firm Innovation</p>
<p>(Room 307, Woosuk Economic Hall)</p>				
<p><u>Parallel Session 1F</u> Agriculture and Rural Development I</p>	<p>1. Beyond the Ban – Shedding Light on Smallholders’ Price Vulnerability in Indonesia’s Palm Oil Industry</p>	<p>2. Demand, Impacts and the Consequences of Mis-Designed Crop Insurance: Evidence from Administrative Data of Nationwide Program in Thailand</p>	<p>3. Aging in a Dual Economy: Urban Aging, Massive Migration, and Agricultural Development</p>	<p>4. Shocks and Brave Farmers: Evidence from a Randomized Agricultural Microfinance Experiment in Bangladesh</p>
<p>(Room 308, Woosuk Economic Hall)</p>				
<p>12:00 pm–12:50 pm</p>	<p>Lunch break (5th Floor, Woosuk Economic Hall)</p>			
<p>1:05 pm–1:35 pm</p>	<p>Agging Well in Asia: Asian Development Policy Report presentation (Room 107, Woosuk Economic Hall)</p>			

1:45 pm–3:45 pm **Sessions 2A–2F**

<p>Parallel Session 2A Asian Development Review I: Climate Change and Pollution</p>	<p>1. Health Effects of Climate Change and Mitigating Effects of Climate Policies: Evidence from Bangladesh</p>	<p>2. Pollution, Information and Migration</p>	<p>3. Exploring the Economic and Non-Economic Determinants of Investments in Renewable Energy</p>
<p>(Room 107, Woosuk Economic Hall)</p>			
<p>Parallel Session 2B Domestic Resource Mobilization and Governance I</p>	<p>1. How Does Corruption Undermine Investment in Learning? Leakages and Inefficiencies in Education Budgets</p>	<p>2. Impact of Terrorism on Consumer Sentiment in Pakistan: A City-Level Analysis</p>	<p>3. The Trickle-Down Effect of Government Debt and Social Unrest 4. Pandemic, Poverty and Policy: Distributional Impact of the COVID-19 Shock in Indonesia</p>
<p>(Room 109, Woosuk Economic Hall)</p>			
<p>Parallel Session 2C Education I</p>	<p>1. The “Good School” Premium in Housing Prices: A Competitive Schooling Perspective</p>	<p>2. Building Resilient Education Systems: Evidence from Large-Scale Randomized Trials in Five Countries</p>	<p>3. Impact of Landmine Risk on Human Capital Accumulation in a Post-conflict Country 4. The Prevalence and Policy Implications of Between-School Heterogeneity in Learning Outcomes: Evidence from Six Public Education Systems</p>
<p>(Room 207, Woosuk Economic Hall)</p>			
<p>Parallel Session 2D Labor II</p>	<p>1. Global Investment and Household Labor Supply: Evidence from Samsung’s Entry in Vietnam</p>	<p>2. Barriers to Labor Migration for the Rural Poor</p>	<p>3. “The profit can’t be compared to the risk.” Examining Decent Work Among Older Women Entrepreneurs in Rural Indonesia</p>
<p>(Room 208, Woosuk Economic Hall)</p>			
<p>Parallel Session 2E Regional Cooperation and Economic Integration I</p>	<p>1. Remittances, Exchange Rates, and the Role of Financial Development</p>	<p>2. Production, Trade, and Cross-Border Data Flows</p>	<p>3. China’s Increasing Global Financial Impact 4. The Value of Trademarks: Micro Evidence from Chinese Exports to Africa</p>
<p>(Room 307, Woosuk Economic Hall)</p>			

Economic Hall)					
	<p>Parallel Session 2F Health I</p> <p>(Room 308, Woosuk Economic Hall)</p>	<p>1. Taking Health for Granted. Can a Narrative about Living with a Disease Increase Preventive Health Information?</p>	<p>2. Nudge for Sanitation: Experimental Evidence from China</p>	<p>3. Physical, Psychological Distress and Mental Well-Being among Gig Workers in India</p>	<p>4. Health Screening and Selection: Evidence from Biennial Subsidies in South Korea</p>
3:45 pm–4:00 pm	<p>Coffee break (Woosuk Economic Hall, 1F/3F)</p>				
4:00 pm–6:00 pm	<p>Sessions 3A–3F Parallel Session 3A Demographics and Gender</p> <p>(Room 107, Woosuk Economic Hall)</p>	<p>1. The Role of Family Support in the Well-Being of Older People: Evidence from Malaysia and Viet Nam</p>	<p>2. Demographic Aging and the New Keynesian Phillips Curve</p>	<p>3. Healthcare Utilization and Informal Care in the Aging Era: Comparative Analysis of China, Japan, and South Korea</p>	
	<p>Parallel Session 3B Domestic Resource Mobilization and Governance II</p> <p>(Room 109, Woosuk Economic Hall)</p>	<p>1. “Helping Hand” or “Grabbing Hand”? The Impact of Government Recentralization on Public Administration and Private Investment</p>	<p>2. What Determines Fiscal Multipliers in China? – The Role of Fiscal Structure</p>	<p>3. Economic Resilience: New Evidence</p>	<p>4. Does Deterrence Treatment Have a Dynamic Impact on Tax Compliance? Insights from Experimental Evidence in Indonesia</p>
	<p>Parallel Session 3C Education II</p> <p>(Room 207, Woosuk Economic Hall)</p>	<p>1. Impacts of In-Person School Days on Student Outcomes and Inequality: Evidence from Korean High Schools during the Pandemic</p>	<p>2. Parental Job Loss and the Child’s Educational Outcomes: The Importance of Timing</p>	<p>3. Complementarity between Global Value Chain Activity and Vocational Education: Evidence from Indonesia</p>	<p>4. Mother Tongue-based Education in a Diverse Society Lowers Foundational Skills: Evidence from the Philippines</p>

<p><u>Parallel Session 3D</u> Poverty and Income Inequality I</p>	<p>1. Income Inequality, Civic Participation, and Political Instability</p>	<p>2. ICT Development and Income Inequality: Evidence from Households</p>	<p>3. Public Sector Wage Policy's Impact on Labor Market Inequality: A Natural Experiment</p>
<p>(Room 208, Woosuk Economic Hall)</p>			
<p><u>Parallel Session 3E</u> Macroeconomics and Finance II</p>	<p>1. Bank Stability and Market Concentration in the Emerging Markets of the ASEAN</p>	<p>2. The Effect of Financial Technology Development on Commercial Banks' Profitability: Experimental Evidence in Vietnamese Commercial Banks from 2008 to 2023</p>	<p>3. Macroprudential Policies and Tail Effects on Growth in India 4. Impact of Oil Price and Its Volatility on CPI of Pakistan: Bivariate EGARCH Model</p>
<p>(Room 307, Woosuk Economic Hall)</p>			
<p><u>Parallel Session 3F</u> Health II</p>	<p>1. Metropolitan Area Delineation and Resilience under Public Health Crisis: Evidence from the Philippines</p>	<p>2. Political Economy of Sanitation in India</p>	<p>3. Does Environment and Health Awareness Matter for Household Fuel Choice? Empirical Evidence from Central Asia</p>
<p>(Room 308, Woosuk Economic Hall)</p>			
<p>6:45 pm–9:00 pm</p>	<p>Conference Dinner (‘Sarsha’, Dongwongwan Building, Bldg. 113, 3rd floor)</p>		
	<p>Moderator</p>	<p>Raeyoon Kang, Professor, Seoul National University</p>	
<p>6:45 pm–6:55 pm</p>	<p>Dinner Remarks</p>	<p>Albert F. Park, Chief Economist, Asian Development Bank</p>	
<p>6:55 pm–7:25 pm</p>	<p>Keynote Speech</p>	<p>Justin Yifu Lin, Dean of Institute of New Structural Economics, Dean of Institute of South-South Cooperation and Development, and Professor and Honorary Dean of National School of Development, Peking University</p>	

14 July 2024, Sunday

8:30am–9:00 am	Registration (Woosuk Economic Hall, Building 223)				
9:00 am–9:30 am	Moderator	Dina Azhgaliyeva , Senior Research Fellow, Asian Development Bank Institute			
	Keynote Speech	Keun Lee , Distinguished Professor, Seoul National University			
	(Room 107, Woosuk Economic Hall)				
9:30 am–9:45 am	Coffee break (Woosuk Economic Hall, 1F/3F)				
9:45 am–11:45 am	Session 4A–4F				
	Parallel Session 4A Asian Development Review II: Inequality, Poverty, and Vulnerability	1. Remotely Sensed Spatial Inequality: Luminosity Evidence from Chinese Cities and Counties	2. Perception Towards Income Inequality in the Process of Economic Development: Evidence from International Panel Data	3. Misfortune Seldom Comes Alone: Evidence from the Compounded COVID-19 and Typhoon Disasters in a Developing Country	4. Rip Off the Red Tape: Government-Business Relationship and Corporate Poverty Alleviation Decisions
	(Room 107, Woosuk Economic Hall)				
	Parallel Session 4B Climate Change and Environment II	1. The Enterprise Carbon Risk Penalty: Evidence Based on the Perspective of Enterprise Debt Financing Cost	2. Climate Change and Corporate Financial Performance	3. Climate Change and Economic Prosperity: Evidence from a Flexible Damage Function	
	(Room 109, Woosuk Economic Hall)				

<p>Parallel Session 4C Gender II</p> <p>(Room 207, Woosuk Economic Hall)</p>	<p>1. Preferences for Wage Discrimination Against Women</p>	<p>2. Becoming "Co-ed": A Protestant Gift to China</p>	<p>3. The Gender Wage Gap and the Task Structure of Jobs: Evidence from Developing Countries</p>
<p>Parallel Session 4D Macroeconomics and Finance III</p> <p>(Room 208, Woosuk Economic Hall)</p>	<p>1. The Dollar Squeeze and Economic Growth</p>	<p>2. Effectiveness of Inflation Targeting in Emerging and Developing Asia: Panel Evidence</p>	<p>3. Journey to the (North, South, East, and) West: Global Spillovers of Chinese Monetary Policy</p> <p>4. Transmission of a Liquidity Shock in India: Banks versus Non-Banks</p>
<p>Parallel Session 4E Health III</p> <p>(Room 307, Woosuk Economic Hall)</p>	<p>1. The Right Timing Matters: Identifying Sensitive Periods in the Formation of Socio-Emotional Skills</p>	<p>2. The Inheritance of Historical Trauma: Intergenerational Effects of Early-Life Exposure to Famine on Mental Health</p>	<p>3. Cigarette Demand in Indonesia with Controls for Cigarette Quality</p>
<p>Parallel Session 4F Regional Cooperation and Economic Integration II</p> <p>(Room 308, Woosuk Economic Hall)</p>	<p>1. Measuring the Contribution of International Remittances to Household Expenditures and Economic Output: A Micro-Macro Analysis for the Philippines</p>	<p>2. Evolving Impact of Global Value Chains on the Exchange Rate Elasticity of Exports: A Time-Varying Coefficients Approach</p>	<p>3. Locating Positions in Global Production Networks: A Cross-Country Examination of Upstream, Midstream, and Downstream Dynamics and its Shock Propagations in Textiles & Clothing Sector</p> <p>4. Unlocking Innovation: The Impact of Free Trade Zones on Corporate Innovation in China</p>
<p>11:45 am–1:15 pm Lunch break (5th Floor, Woosuk Economic Hall)</p>			
<p>1:15 pm–2:45 pm Session 5A–5F</p>			

<p>Parallel Session 5A Agriculture and Rural Development II</p>	<p>1. Information Provision and Risk Attitudes of Subsistence Tribal Farmers in Eastern India: Evidence from Field experiments</p>	<p>2. Distributional Effects of Indian Agricultural Interventions</p>	<p>3. Urban-Rural Migration and Agricultural Production: Evidence from Returning Family Migrants</p>
<p>Parallel Session 5B Climate Change and Environment III</p>	<p>1. Factors Influencing Climate Change Adaptation Among Farmers in the Mekong Delta</p>	<p>2. Weather Shocks and Economic Well-Being in Indonesia</p>	<p>3. Short-Run Impacts of Floods: A Case Study from India</p>
<p>Parallel Session 5C Gender III</p>	<p>1. Trade and Gendered Labor Outcomes: Evidence from Changing Export Demand in Indonesia</p>	<p>2. Gender Differences in Retirement Wellbeing</p>	<p>3. Bridging the Gender Gap in Entrepreneurship and Empowering Women via Digital Technologies</p>
<p>Parallel Session 5D Regional Cooperation and Economic Integration III</p>	<p>1. Global Shocks and Monetary Policy Transmission in Emerging Markets</p>	<p>2. The Effect of the China Connect</p>	<p>3. Do Non-Monetary Forms of Remittances Matter for Entrepreneurship Development? Evidence from Filipino Migrants in Japan</p>
<p>Parallel Session 5E Macroeconomics and Finance IV</p>	<p>1. Luminosity and Local Economic Growth</p>	<p>2. The Lending Implications of Loan Loss Provisions and Monetary Policy in Indonesia</p>	<p>3. Learning from Neighbors: Peer Effects in Chinese Household Financial Investments</p>

	<p>Parallel Session 5F Labor III</p> <p>(Room 308, Woosuk Economic Hall)</p>	<p>1. The Effect of Fringe Benefit Tax on Wages: Evidence from India</p>	<p>2. Expanding Workers' Social Protection Schemes for Informal Workers in Indonesia: Between Urgency and Necessity</p>	<p>3. The Minimum Wage Effects on Earnings and Sorting</p>
<p>2:45 pm–3:00 pm</p>	<p>Coffee break (Woosuk Economic Hall, 1F/3F)</p>			
<p>3:00 pm–4:30 pm</p>	<p>Sessions 6A–6F</p>			
	<p>Parallel Session 6A Climate Change, Energy, and Environment</p> <p>(Room 107, Woosuk Economic Hall)</p>	<p>1. The Distributional Effects of Climate Change. An Empirical Analysis</p>	<p>2. Do Power Outages Hurt Export Performance? Evidence from a Firm-Level Survey</p>	<p>3. Domestic Pollution Havens: Linking Interregional Capital Flight and Water Pollution Regulation in China</p>
	<p>Parallel Session 6B Domestic Resource Mobilization and Governance III</p> <p>(Room 109, Woosuk Economic Hall)</p>	<p>1. Politics of Transfers in Indonesia: Evidence from Regression Discontinuity Design</p>	<p>2. The Effects of Tax Holidays on Investment and Innovation: A Firm-level Data Analysis in Thailand</p>	<p>3. The Effects of Indonesia's Country-by-Country Reporting Regulation on Investment</p>
	<p>Parallel Session 6C Regional Cooperation and Economic Integration IV</p> <p>(Room 207, Woosuk Economic Hall)</p>	<p>1. Navigating Global Value Chains: An Analysis of The Indonesian Electronics Industry's Impact on International Trade, Labor, and Collaborative Relationship</p>	<p>2. Are Unexpected Guests Welcomed by Hosts?: Evidence on How Natives Respond to Sudden Asylum Seeker Influx</p>	<p>3. Questioning the Quality: Reputational Impact on Indian Pharmaceutical Exports</p>

Parallel Session 6D
Poverty and Inequality II

(Room 208, Woosuk Economic Hall)

1. Financial Literacy and Fintech Use in Family Business: Evidence from Developing Asia

2. Rainfall, Health Risks, and Socioeconomic Vulnerability in Environmentally Vulnerable Populations

3. What “Causes” Income Inequality? Technological Innovation versus Financialization

Parallel Session 6E
Macroeconomics and Finance V

(Room 307, Woosuk Economic Hall)

1. Indonesian Household Asset Allocation Behavior

2. A Generalized Model of Growth in the Data Economy

3. Unpacking the Determinants of Financial Resilience in the Philippines

Parallel Session 6F
Health and Gender

(Room 308, Woosuk Economic Hall)

1. Long-term Impacts of Growth and Development Monitoring: Evidence from Routine Health Examinations in Early Childhood

2. Shaping Gender Role Attitudes: The Influence of Parental Occupational Differences on the Next Generation

3. Unintended Consequences of Family Planning Policies on the Breastfeeding Gap between Sons and Daughter

4:30 pm **End of Conference**

Note: The Asian Development Bank recognizes “China” as the People’s Republic of China; “Hong Kong” as Hong Kong, China; “Korea” and “South Korea” as the Republic of Korea; “Macau” as Macau, China; and “Vietnam” as Viet Nam.

Conference Venue

The Asian Economic Development Conference 2024 will be held at **Seoul National University (SNU), 1 Gwanak-ro, Gwanak-gu, Seoul, Republic of Korea**. The conference venue in SNU is **Woosuk Economic Hall, Building 223**.

The **conference registration, opening session, first day keynote speech (13 July), and second day keynote speech (14 July)** will be conducted in **Woosuk Economic Hall**.

All **parallel sessions** will be held in the following venues:

- Parallel session A: Room 107 (160 people), Woosuk Economic Hall, Building 223
- Parallel session B: Room 109 (36 people), Woosuk Economic Hall, Building 223
- Parallel session C: Room 207 (30 people), Woosuk Economic Hall, Building 223
- Parallel session D: Room 208 (30 people), Woosuk Economic Hall, Building 223
- Parallel session E: Room 307 (54 people), Woosuk Economic Hall, Building 223
- Parallel session F: Room 308 (24 people), Woosuk Economic Hall, Building 223

Conference Lunches (13–14 July)

Lunches will be serviced on both 13 and 14 July at the 5th Floor, Woosuk Economic Hall, Building 223.

Coffee Breaks (13–14 July)

Coffee and tea with some light refreshment (cookies) will be available at the first/third floor of Woosuk Economic Hall, Building 223.

SNU Campus Map

Campus map: from the university main gate to the conference venue:
Seoul National University, Woosuk Economic Hall, Building 223

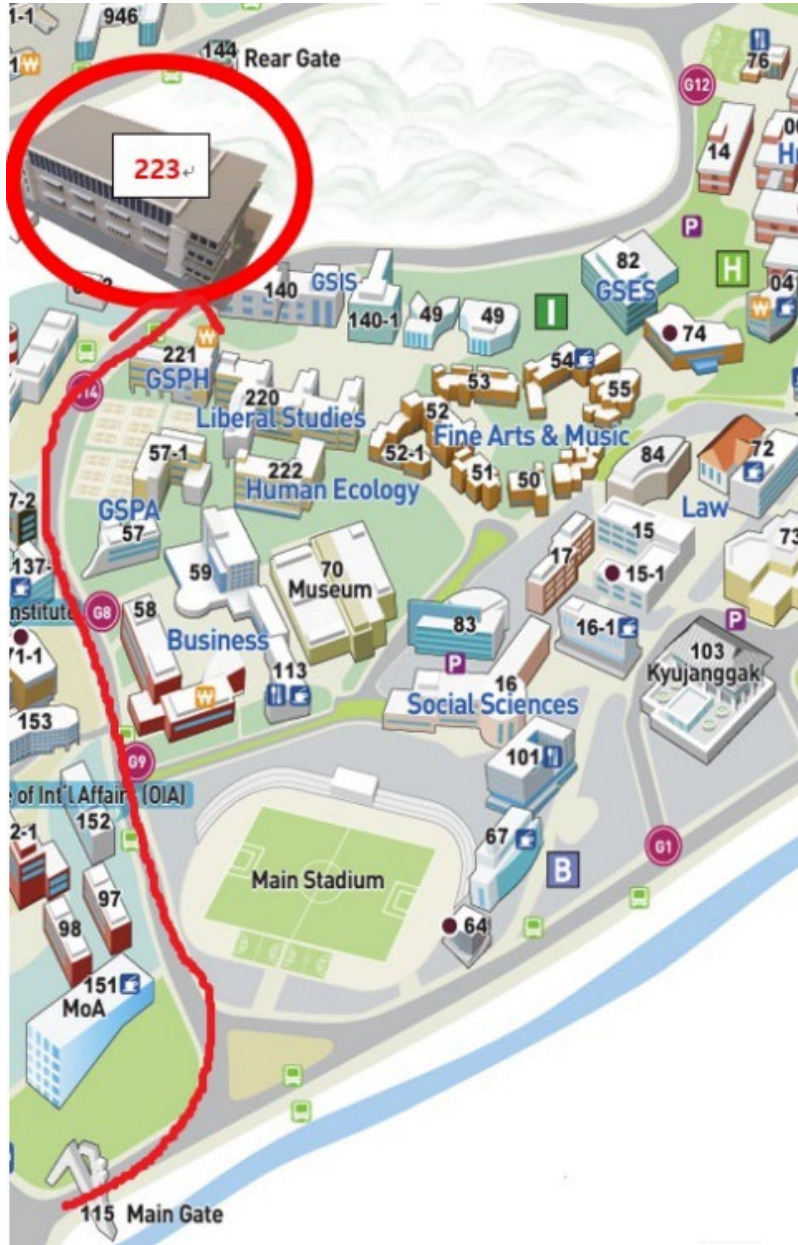

Presenters and Discussants

13 July 2024, Saturday (10:00 am–12:00 noon)
Room 107, Woosuk Economic Hall

Session 1A: Climate Change and Environment I

Moderator: Albert Park, Asian Development Bank

Fossil Fuel Subsidies and GHG Emissions: Firm-level Empirical Evidence from Developing Asia

- Dina Azhgaliyeva* (ADBI) and Hai Le (ADBI)
- Discussant: Yujie Zhang

Are Natural Disasters Disastrous for Learning? Evidence from Seven Asian Countries

- Yujie Zhang* (University of Houston), Jere R. Behrman (University of Pennsylvania), Emily Hannum (University of Pennsylvania), Minhaj Mahmud (ADB), and Fan Wang (University of Houston)
- Discussant: Rhea Molato-Gayares

Lead Exposure from Toxic Sites and Cognitive Skills: Evidence from Indonesia

- Emilie Berkhout (Youth Impact), Sandy Maulana (ADBI), Rhea Molato-Gayares* (ADB), Albert Park (ADB), and Daniel Suryadarma (ADBI)
- Discussant: Alex Eapen

Air Pollution Policy and Labor Productivity - Economic Benefits from Demand for Clean Air

- Hang Dang* (The World Bank) and Alex Eapen* (Australian National University)
- Discussant: Dina Azhgaliyeva

* Presenter

[<< Go back to main agenda](#)

13 July 2024, Saturday (10:00 am–12:00 noon)
Room 109, Woosuk Economic Hall

Session 1B: Gender I

Moderator: Joseph Zveglic, Jr., Asian Development Bank

Unintended Effects of Delayed Marriage on Women's Attitudes Toward Intimate Partner Violence: Evidence from Cambodia

- [Yuki Kanayama*](#) (Cambodia Development Research Institute)
- Discussant: Lolita Moorena

Women's Labor Supply, Decision Making Power, and Cultural Norms: Evidence from Indonesia's Domestic Violence Law

- [Lolita Moorena*](#) (Australian National University)
- Discussant: Romora Edward Sitorus

Training Intensity and Female Labour Market Outcomes: Evidence from Indonesia during COVID-19 Pandemic

- [Romora Edward Sitorus*](#) (Project Management Office of Kartu Prakerja Program, Coordinating Ministry for Economic Affairs of the Republic of Indonesia), Amirah Jinan Dhia (Project Management Office of Kartu Prakerja Program, Coordinating Ministry for Economic Affairs of the Republic of Indonesia), Daniera Nanda Ariefti (Project Management Office of Kartu Prakerja Program, Coordinating Ministry for Economic Affairs of the Republic of Indonesia), Rizki Fajar Pangestu (Project Management Office of Kartu Prakerja Program, Coordinating Ministry for Economic Affairs of the Republic of Indonesia), Alfiansyah Achmad (Project Management Office of Kartu Prakerja Program, Coordinating Ministry for Economic Affairs of the Republic of Indonesia), Ni Putu Mia Tarani (Project Management Office of Kartu Prakerja Program, Coordinating Ministry for Economic Affairs of the Republic of Indonesia), Dyah Pritadrajati (Australian National University), and Bambang Brodjonegoro (University of Indonesia)
- Discussant: Ming-ang Zhang

Sex Imbalance and Female Resilience: Insights from China's College Entrance Examinations

- Shiqi Guo (Shanghai Jiao Tong University), Xinzheng Shi (Tsinghua University), and [Ming-ang Zhang*](#) (Central University of Finance and Economics)
- Discussant: Yuki Kanayama

*Presenter

[<< Go back to main agenda](#)

13 July 2024, Saturday (10:00 am–12:00 noon)
Room 207, Woosuk Economic Hall

Session 1C: Labor I

Moderator: Bonggeun Kim, Seoul National University

Prevalent Informality and Labour Allocation

- [Fajar Oktiyanto*](#) (Australian National University)
- Discussant: Shantanu Khanna

Does Access to Credit Reduce Child Labor? New Evidence from Bangladesh

- [Farzana Munshi*](#) (Brac University and University of Manchester), KM Arefin Kamal (Brac University), and David Fielding (University of Manchester)
- Discussant: Shantanu Khanna

Child Labour in India: Long Term Trends and Measurement Issues

- [Shantanu Khanna*](#) (Northeastern University), Udayan Rahore (Oxford Policy Management), and Naveen Kumar (Delhi School of Economics)
- Discussant: Jin Ho Kim

Meat or Poison? Minimum Wages for Chinese Firms and Workers

- Ida Brzezinska (Oxford Policy Management), [Jin Ho Kim*](#) (Cardi University), and Zhaohe Yang (Hang Seng Bank China)
- Discussant: Fajar Oktiyanto

*Presenter

[<< Go back to main agenda](#)

13 July 2024, Saturday (10:00 am–12:00 noon)
Room 208, Woosuk Economic Hall

Session 1D: Macroeconomics and Finance I

Moderator: Donghyun Park, Asian Development Bank

Estimating the Impact of BSP Policy Adjustments on Bank Lending: A Panel VAR Model Approach

- [Joan Christine S. Allon-Pineda*](#) (Bangko Sentral ng Pilipinas), [Sarah Jane A. Castañares*](#) (Bangko Sentral ng Pilipinas), [Jasmin E. Dacio](#) (Bangko Sentral ng Pilipinas), [Justin S. Eloriaga](#) (Emory University), [Shirra Jazel L. De Guia](#) (Bangko Sentral ng Pilipinas), and [Maureen Ane D. Rosellon](#) (Bangko Sentral ng Pilipinas)
- Discussant: [Nuwat Nookhwun](#)

Disaggregated Inflation Dynamics in Thailand: Which Shocks Matter?

- [Nuwat Nookhwun*](#) (Bank of Thailand) and [Pym Manopimoke](#) (Bank of Thailand)
- Discussant: [Kanupriya Sharma](#)

Inflation Convergence Dynamics in India: An Analysis of Headline and Core Inflation

- [Anupam Prakash](#) (Reserve Bank of India), [Silu Muduli](#) (Reserve Bank of India), and [Kanupriya Sharma*](#) (Reserve Bank of India)
- Discussant: [Syed Zulqernain Hussain](#)

Inflation: The Macroeconomic Consequence of Terror Activity in Pakistan

- [Syed Zulqernain Hussain*](#) (University of Otago)
- Discussant: [Joan Christine S. Allon-Pineda](#)

*Presenter

[<< Go back to main agenda](#)

13 July 2024, Saturday (10:00 am–12:00 noon)
Room 307, Woosuk Economic Hall

Session 1E: Digital Economy and Innovation

Moderator: Peter Morgan, Asian Development Bank Institute

Identifying Growth Effect of Internet Penetration

- [Mengyuan Cai*](#) (Nanyang Technological University) and Guiying Laura Wu (Nanyang Technological University)
- Discussant: Daeyong Kim

Investigating the Key Factors Affecting Innovative Capacity in Asian Countries

- [Hyunyi Choi*](#) (Korea Development Institute) and Daeyong Kim (Korea Development Institute)
- Discussant: Han Qiu

Digital Money Demand and Monetary Policy

- Rongyu Cui (Institute of Digital Finance and National School of Development, Peking University), Leonardo Gambacorta (BIS and CEPR), Yiping Huang (Institute of Digital Finance and National School of Development, Peking University), and [Han Qiu*](#) (BIS)
- Discussant: Cheryl Xiaoning Long

Inventor Mobility and Firm Innovation

- Shimei Huang (Xiamen University), Lingzi Liu (Xiamen University Malaysia), [Cheryl Xiaoning Long*](#) (Xiamen University Malaysia)
- Discussant: Mengyuan Cai

*Presenter

[<< Go back to main agenda](#)

13 July 2024, Saturday (10:00 am–12:00 noon)
Room 308, Woosuk Economic Hall

Session 1F: Agriculture and Rural Development I

Moderator: Sujata Visaria, City, University of London

Beyond the Ban – Shedding Light on Smallholders' Price Vulnerability in Indonesia's Palm Oil Industry

- Charlotte Reich* (Georg-August-University)
- Discussant: Chonnakan Rittinon

Demand, Impacts and the Consequences of Mis-Designed Crop Insurance: Evidence from Administrative Data of Nationwide Program in Thailand

- Boontida Sa-ngimnet (Bank of Thailand), Chonnakan Rittinon* (Bank of Thailand), and Sommarat Chantararat (Bank of Thailand)
- Discussant: Suqin Ge

Aging in a Dual Economy: Urban Aging, Massive Migration, and Agricultural Development

- Suqin Ge* (Virginia Tech), Junsen Zhang (Zhejiang University, Chinese University of Hong Kong), and Kang Zhou (Zhejiang University)
- Discussant: Yasuyuki Sawada

Shocks and Brave Farmers: Evidence from a Randomized Agricultural Microfinance Experiment in Bangladesh

- Md Amzad Hossain (University of Arkansas), Mohammad Abdul Malek (University of Tokyo), and Yasuyuki Sawada* (University of Tokyo)
- Discussant: Charlotte Reich

*Presenter

[<< Go back to main agenda](#)

13 July 2024, Saturday (1:45 pm–3:45 pm)
Room 107, Woosuk Economic Hall

Session 2A: Asian Development Review I – Climate Change and Pollution

Moderator: John Gibson, University of Waikato

Health Effects of Climate Change and Mitigating Effects of Climate Policies: Evidence from Bangladesh

- Shaikh M.S.U. Eskander (Grantham Research Institute on Climate Change and the Environment and Centre for Climate Change Economics and Policy, London School of Economics and Political Science) and [Minhaj Mahmud*](#) (ADB)
- Discussant: Mingda Wang

Pollution, Information and Migration

- [Mingda Wang*](#) (Central University of Finance and Economics)
- Discussant: Gazi Salah Uddin

Exploring the Economic and Non-Economic Determinants of Investments in Renewable Energy

- [Gazi Salah Uddin*](#) (Linköping University), Md. Bokhtiar Hasan (Islamic University) Donghyun Park (ADB), and Md. Sumon Ali (Islamic University)
- Discussant: Minhaj Mahmud

*Presenter

[<< Go back to main agenda](#)

13 July 2024, Saturday (1:45 pm–3:45 pm)
Room 109, Woosuk Economic Hall

Session 2B: Domestic Resource Mobilization and Governance I

Moderator: Seungju Baek, Asian Development Bank Institute

How does Corruption Undermine Investment in Learning? Leakages and Inefficiencies in Education Budgets

- [Raymond Gaspar*](#) (Bond University), Kuldeep Kumar (Bond University), and Neil Campbell (Bond University)
- Discussant: Syed Zulqernain Hussain

Impact of Terrorism on Consumer Sentiment in Pakistan: A City-Level Analysis

- [Syed Zulqernain Hussain*](#) (University of Otago)
- Discussant: Ben Charoenwong

The Trickle-Down Effect of Government Debt and Social Unrest

- [Ben Charoenwong*](#) (National University of Singapore)
- Discussant: Raymond Gaspar

Pandemic, Poverty and Policy: Distributional Impact of the COVID-19 Shock in Indonesia

- Sailesh Tiwari (The World Bank), [Virgi Agita Sari*](#) (London School of Economics and Political Science), Citra Kumala (United Nations), Imam Setiawan (The World Bank), and Juul Pinxten (The World Bank)

*Presenter

[<< Go back to main agenda](#)

13 July 2024, Saturday (1:45 pm–3:45 pm)
Room 207, Woosuk Economic Hall

Session 2C: Education I

Moderator: Youjin Hahn, Yonsei University

The “Good School” Premium in Housing Prices: A Competitive Schooling Perspective

- Shang-Jin Wei (Columbia University), Jing Wu (Tsinghua University), and [Rongjie Zhang*](#) (Tsinghua University)
- Discussant: Karisha Anne Cruz

Building Resilient Education Systems: Evidence from Large-Scale Randomized Trials in Five Countries

- Noam Angrist (Oxford University and Youth Impact), Michael Ainomugisha (Building Tomorrow), Sai Pramod Bathena (Alokit), Peter Bergman (University of Texas at Austin), Colin Crossley (Youth Impact), Claire Cullen (Oxford University and Youth Impact), Thato Letsomo (Youth Impact), Moitshepi Matsheng (Youth Impact), Rene Marlon Panti (Innovations for Poverty Action), Shwetlena Sabarwal (World Bank), Tim Sullivan (NewGlobe), and [Karisha Anne Cruz*](#) (Innovations for Poverty Action)
- Discussant: Soyoung Kim

Impact of Landmine Risk on Human Capital Accumulation in a Post-conflict Country

- [Soyoung Kim*](#) (University of Tokyo)
- Discussant: Daniel Rodriguez-Segura

The Prevalence and Policy Implications of Between-School Heterogeneity in Learning Outcomes: Evidence from Six Public Education Systems

- [Daniel Rodriguez-Segura*](#) (NewGlobe) and Savannah Tierney (NewGlobe)
- Discussant: Rongjie Zhang

*Presenter

[<< Go back to main agenda](#)

13 July 2024, Saturday (1:45 pm–3:45 pm)
Room 208, Woosuk Economic Hall

Session 2D: Labor II

Moderator: Shu Tian, Asian Development Bank

Global Investment and Household Labor Supply: Evidence from Samsung's Entry in Vietnam

- Thi Kim Dung Dang* (KDI School of Public Policy and Management), Changkeun Lee (KDI School of Public Policy and Management), and David Sungho Park (KDI School of Public Policy and Management)
- Discussant: Tomoki Fujii

Barriers to Labor Migration for the Rural Poor

- Abu S. Shonchoy (Florida International University), Tomoki Fujii* (Singapore Management University), and Selim Raihan (University of Dhaka)
- Discussant: Sylvia Szabo

“The profit can't be compared to the risk.” Examining Decent Work Among Older Women Entrepreneurs in Rural Indonesia

- Ernis Asanti (SurveyMETER, Special Region of Yogyakarta, Indonesia), Ni Wayan Suriastini (SurveyMETER, Special Region of Yogyakarta, Indonesia), Sylvia Szabo* (HelpAge International), Eva AJ Sabdono (Yayasan Emong Lansia), Fita Herawati (SurveyMETER, Special Region of Yogyakarta, Indonesia), Babken Babajanian (HelpAge International), Titis Ambarwati (SurveyMETER, Special Region of Yogyakarta, Indonesia), and Worawat Srisawasdi (Chulalongkorn University).
- Discussant: Erik Hille

The Effect of Energy Prices on Employment: Evidence from a Developing Country

- Erik Hille* (HHL Leipzig Graduate School of Management) and Cian Angerpointner (HHL Leipzig Graduate School of Management)
- Discussant: Thi Kim Dung Dang

*Presenter

[<< Go back to main agenda](#)

13 July 2024, Saturday (1:45 pm–3:45 pm)
Room 307, Woosuk Economic Hall

Session 2E: Regional Cooperation and Economic Integration I

Moderator: Jinhee Kim, Seoul National University and Institute for Energy Research

Remittances, Exchange Rates, and the Role of Financial Development

- [John Beirne*](#) (ADB), Pradeep Panthi (ADBI), and Guna Raj Bhatta (Nepal Rastra Bank)
- Discussant: Qing Chang

Production, Trade, and Cross-Border Data Flows

- [Qing Chang*](#) (Central University of Finance and Economics), Lin William Cong (Cornell University and NBER), Liyong Wang (Central University of Finance and Economics), and Longtian Zhang (Central University of Finance and Economics)
- Discussant: Chang Ma

China's Increasing Global Financial Impact

- [Chang Ma*](#) (Fudan University), Alessandro Rebucci (Johns Hopkins University and CEPR, and NBER), and Sili Zhou (University of Macau)
- Discussant: Yusuke Kuroishi

The Value of Trademarks: Micro Evidence from Chinese Exports to Africa

- [Yusuke Kuroishi*](#) (Hitotsubashi University)
- Discussant: John Beirne

*Presenter

[<< Go back to main agenda](#)

13 July 2024, Saturday (1:45 pm–3:45 pm)
Room 308, Woosuk Economic Hall

Session 2F: Health I

Moderator: Dina Azhgaliyeva, Asian Development Bank Institute

Taking Health for Granted. Can a Narrative about Living with a Disease Increase Preventive Health Information?

- Huan Wang* (University of Melbourne)
- Discussant: Yanlin Wan

Nudge for Sanitation: Experimental Evidence from China

- Yanlin Wan* (Hong Kong University of Science and Technology) and Xu Zhang (Hong Kong University of Science and Technology, Guangzhou)
- Discussant: Raja Rajendra Timilsina

Physical, Psychological Distress and Mental Well-Being among Gig Workers in India

- Raja Rajendra Timilsina* (ADBI)
- Discussant: Siho Park

Health Screening and Selection: Evidence from Biennial Subsidies in South Korea

- Siho Park* (University of Illinois Urbana-Champaign)
- Discussant: Huan Wang

*Presenter

[<< Go back to main agenda](#)

13 July 2024, Saturday (4:00 pm–6:00 pm)
Room 107, Woosuk Economic Hall

Session 3A: Demographics and Gender

Moderator: Aiko Kikkawa, Asian Development Bank

The Role of Family Support in the Well-Being of Older People: Evidence from Malaysia and Viet Nam

- Yana van der Meulen Rodgers (Rutgers University), [Joseph E. Zveglich, Jr.* \(ADB\)](#), Khadija Ali (ADB), and Hanna Xue (Rutgers University)
- Discussant: Gene Ambrocio

Demographic Aging and the New Keynesian Phillips Curve

- [Gene Ambrocio* \(Bank of Finland\)](#)
- Discussant: Yuhang Pan

Healthcare Utilization and Informal Care in the Aging Era: Comparative Analysis of China, Japan, and South Korea

- Wanrui Wu (Peking University and Yale University), Gordon Liu (Peking University), and [Yuhang Pan* \(Peking University\)](#)
- Discussant: Joseph E. Zveglich, Jr.

*Presenter

[<< Go back to main agenda](#)

13 July 2024, Saturday (4:00 pm–6:00 pm)
 Room 109, Woosuk Economic Hall

Session 3B: Domestic Resource Mobilization and Governance II

Moderator: Yothin Jinjarak, Asian Development Bank

“Helping Hand” or “Grabbing Hand”? The Impact of Government Recentralization on Public Administration and Private Investment

- Hiep Ngoc Luu (University of Leeds), Kieu Trang Vu (University of Leeds), [Muhammad Ali Nasir*](#) (University of Leeds), Lan Thi Mai Nguyen (University of Leeds), and Tuong-Anh Thi Nguyen (University of Leeds)
- Discussant: Huanhuan Zheng/ Hanmin Dong

What Determines Fiscal Multipliers in China? – The Role of Fiscal Structure

- [Hanmin Dong*](#) (National University of Singapore), Yothin Jinjarak (ADB), Akiko Terada-Hagiwara (ADB), and [Huanhuan Zheng*](#) (National University of Singapore)
- Discussant: Donghyun Park

Economic Resilience: New Evidence

- Barry Eichengreen (University of California, Berkeley), [Donghyun Park*](#) (ADB), and Kwanho Shin (Korea University)
- Discussant: Agung Satyadini

Does Deterrence Treatment Have a Dynamic Impact on Tax Compliance? Insights from Experimental Evidence in Indonesia

- [Agung Satyadini*](#) (ANU Crawford School of Public Policy) and Mathias Sinning (ANU Crawford School of Public Policy)
- Discussant: Muhammad Ali Nasir

*Presenter

[<< Go back to main agenda](#)

13 July 2024, Saturday (4:00 pm–6:00 pm)
Room 207, Woosuk Economic Hall

Session 3C: Education II

Moderator: Yasuyuki Sawada, University of Tokyo

Impacts of In-Person School Days on Student Outcomes and Inequality: Evidence from Korean High Schools during the Pandemic

- Youjin Hahn (Yonsei University), [Hyuncheol Bryant Kim*](#) (Hong Kong University of Science and Technology), and Hee-Seung Yang (Yonsei University)
- Discussant: Xinwei Dong

Parental Job Loss and the Child's Educational Outcomes: The Importance of Timing

- [Xinwei Dong*](#) (Huazhong University of Science and Technology)
- Discussant: Rashesh Shrestha

Complementarity between Global Value Chain Activity and Vocational Education: Evidence from Indonesia

- [Rashesh Shrestha](#) (Economic Research Institute for ASEAN and East Asia)* and Debora Winkler (Global Economic Policy)
- Discussant: Daniel Suryadarma

Mother Tongue-based Education in a Diverse Society Lowers Foundational Skills: Evidence from the Philippines

- Takiko Igarashi (ADBI), Sandy Maulana (ADBI), and [Daniel Suryadarma*](#) (ADBI)
- Discussant: Hyuncheol Bryant Kim

*Presenter

[<< Go back to main agenda](#)

13 July 2024, Saturday (4:00 pm–5:30 pm)
Room 208, Woosuk Economic Hall

Session 3D: Poverty and Inequality I

Moderator: Keun Lee, Seoul National University

Income Inequality, Civic Participation, and Political Instability

- Ahlidin Malikov (Westminster International University in Tashkent and University of Westminster) and Behzod Alimov* (Westminster International University in Tashkent and CERGE-EI Foundation)
- Discussant: Shu Tian

ICT Development and Income Inequality: Evidence from Households

- Shu Tian* (ADB) and Yu Wu (Southwestern University of Finance and Economics)
- Discussant: Mehrab Bakhtiar

Public Sector Wage Policy's Impact on Labor Market Inequality: A Natural Experiment

- Md. Al-Hasan (International Food Policy Research Institute), Mehrab Bakhtiar* (International Food Policy Research Institute), Syed Abul Basher (East West University), and Salim Rashid (University of Illinois, Urbana – Champaign)
- Discussant: Behzod Alimov

*Presenter

[<< Go back to main agenda](#)

13 July 2024, Saturday (4:00 pm–6:00 pm)
Room 307, Woosuk Economic Hall

Session 3E: Macroeconomics and Finance II

Moderator: Raja Rajendra Timilsina, Asian Development Bank Institute

Bank Stability and Market Concentration in the Emerging Markets of the ASEAN

- Jovi C. Dacanay* (University of Asia and the Pacific)
- Discussant: Dao My Hang

The Effect of Financial Technology Development on Commercial Banks' Profitability:
Experimental Evidence in Vietnamese Commercial Banks from 2008 to 2023

- Dao My Hang* (Banking Academy), Dong Thi Thanh Nhan* (Corvinus University of Budapest), and Vu Hoang Trung* (University of Economics and Business)
- Discussant: Anirban Sanyal

Macroprudential Policies and Tail Effects on Growth in India

- Anirban Sanyal* (Reserve Bank of India) and Sanjay Singh (Reserve Bank of India)
- Discussant: Abida Naurin

Impact of Oil Price and Its Volatility on CPI of Pakistan: Bivariate EGARCH Model

- Abida Naurin* (Pakistan Institute of Development Economics)
- Discussant: Jovi C. Dacanay

* Presenter

[<< Go back to main agenda](#)

13 July 2024, Saturday (4:00 pm–5:30 pm)
Room 308, Woosuk Economic Hall

Session 3F: Health II

Moderator: Raeyoon Kang, Seoul National University

Metropolitan Area Delineation and Resilience under Public Health Crisis: Evidence from the Philippines

- Yi Jiang* (ADB) and Jade Laranjo* (ADB)
- Discussant: Nilanjan Banik

Political Economy of Sanitation in India

- Anurag Banerjee (Durham University Business School), Nilanjan Banik* (Mahindra University), and Pranjal Chandrakar (Mahindra University)
- Discussant:
-

Does Environment and Health Awareness Matter for Household Fuel Choice? Empirical Evidence from Central Asia

- Dina Azhgaliyeva* (ADBI), Wataru Kodama (ADBI and University of Göttingen), and Hans Holzhacker (CAREC Institute)
- Discussant: Yi Jiang

* Presenter

[<< Go back to main agenda](#)

14 July 2024, Sunday (9:45 am–11:45 am)
Room 107, Woosuk Economic Hall

Session 4A: Asian Development Review II– Inequality, Poverty, and Vulnerability

Moderator: John Gibson, University of Waikato

Remotely Sensed Spatial Inequality: Luminosity Evidence from Chinese Cities and Counties

- [Yilin Chen*](#) (Nagoya University)
- Discussant: Wannaphong Durongkaveroj

Perception Towards Income Inequality in the Process of Economic Development: Evidence from International Panel Data

- [Wannaphong Durongkaveroj*](#) (Ramkhamhaeng University)
- Discussant: Yingxue Jin

Misfortune Seldom Comes Alone: Evidence from the Compounded COVID-19 and Typhoon Disasters in a Developing Country

- [Yingxue Jin*](#) (Hitotsubashi University), Makiko Nakamuro (Keio University), Yasuyuki Sawada (University of Tokyo), Andrew S. Griffen (University of Tokyo), Tsend-Ayush Sosorbaram (Georgetown University), and Yukichi Mano (Hitotsubashi University)
- Discussant: Zhen Wang

Rip Off the Red Tape: Government–Business Relationship and Corporate Poverty Alleviation Decisions

- [Zhen Wang](#) (Central University of Finance and Economics) and Kai Wu (Central University of Finance and Economics)
- Discussant: Yilin Chen

* Presenter

[<< Go back to main agenda](#)

14 July 2024, Sunday (9:45 am–11:45 am)
Room 109, Woosuk Economic Hall

Session 4B: Climate Change and Environment II

Moderator: Yasuyuki Sawada, University of Tokyo

The Enterprise Carbon Risk Penalty: Evidence Based on the Perspective of Enterprise Debt Financing Cost

- [Qiuxian Hu*](#) (Soochow University)
- Discussant: Dina Azhgaliyeva

Climate Change and Corporate Financial Performance

- Lian Liu (Musashino University), John Beirne (ADB), [Dina Azhgaliyeva*](#) (ADBI), and Dil Rahut (ADBI)
- Discussant: Rodolphe Desbordes

Climate Change and Economic Prosperity: Evidence from a Flexible Damage Function

- [Rodolphe Desbordes*](#) (SKEMA Business School) and Markus Eberhardt (University of Nottingham and Centre for Economic Policy Research)
- Discussant: Qiuxian Hu

*Presenter

[<< Go back to main agenda](#)

14 July 2024, Sunday (9:45 am–11:45 am)
Room 207, Woosuk Economic Hall

Session 4C: Gender II

Moderator: Shu Tian, Asian Development Bank

Preferences for Wage Discrimination Against Women

- William Seitz* (The World Bank)
- Discussant: Ningning Ma

Becoming "Co-ed": A Protestant Gift to China

- Ningning Ma* (Jinan University), Se Yan (Peking University), and Yiling Zhao (Peking University)
- Discussant: Bilal Muhammad Khan

The Gender Wage Gap and the Task Structure of Jobs: Evidence from Developing Countries

- Bilal Muhammad Khan* (ADB)
- Discussant: William Seitz

* Presenter

[<< Go back to main agenda](#)

14 July 2024, Sunday (9:45 am–11:45 am)
Room 208, Woosuk Economic Hall

Session 4D: Macroeconomics and Finance III

Moderator: Daniel Suryadarma, Asian Development Bank Institute

- [Jamus Jerome Lim*](#) (ESSEC Business School) and Xin Long (ESSEC Business School)
- Discussant: Nishat Tasnim Anika

Effectiveness of Inflation Targeting in Emerging and Developing Asia: Panel Evidence

- [Nishat Tasnim Anika*](#) (Research and Policy Integration for Development)
- Discussant: Harrison Shieh

Journey to the (North, South, East, and) West: Global Spillovers of Chinese Monetary Policy

- [Harrison Shieh*](#) (University of California Santa Cruz) and Anirban Sanyal (Reserve Bank of India)
- Discussant: K. M. Neelima

Transmission of a Liquidity Shock in India: Banks versus Non-Banks

- [K. M. Neelima*](#) (Reserve Bank of India) and Arpita Agarwal (Reserve Bank of India)
- Discussant: Jamus Jerome Lim

* Presenter

[<< Go back to main agenda](#)

14 July 2024, Sunday (9:45 am–11:45 am)
Room 307, Woosuk Economic Hall

Session 4E: Health III

Moderator: Minhaj Mahmud, Asian Development Bank

The Right Timing Matters: Identifying Sensitive Periods in the Formation of Socio-Emotional Skills

- Laura Bretkopf (Max Planck Institute for Research on Collective Goods), [Shyamal Chowdhury*](#) (University of Sydney), Daniel A. Kamhöfer (Heinrich Heine University), Hannah Schildberg-Hörisch (Heinrich Heine University), and Matthias Sutter (Max Planck Institute for Research on Collective Goods)
- Discussant: Jun Hyung Kim

The Inheritance of Historical Trauma: Intergenerational Effects of Early-Life Exposure to Famine on Mental Health

- Zihan Zhang (Jinan University) and [Jun Hyung Kim](#) (Korea Advanced Institute of Sciences and Technology and IZA Institute of Labor Economics)
- Discussant: Susan Olivia

Cigarette Demand in Indonesia with Controls for Cigarette Quality

- John Gibson (University of Waikato) and [Susan Olivia*](#) (University of Waikato)
- Discussant: Shyamal Chowdhury

* Presenter

[<< Go back to main agenda](#)

14 July 2024, Sunday (9:45 am–11:45 am)
Room 308, Woosuk Economic Hall

Session 4F: Regional Cooperation and Economic Integration II

Moderator: John Beirne, Asian Development Bank

Measuring the Contribution of International Remittances to Household Expenditures and Economic Output: A Micro–Macro Analysis for the Philippines

- [Aiko Kikkawa*](#) (ADB), Raymond Gaspar (Bond University), Kijin Kim (ADB), Mahinthan J. Mariasingham (ADB), and Christian Marvin Zamora (ADB)
- Discussant: Adrian Mendoza

Evolving Impact of Global Value Chains on the Exchange Rate Elasticity of Exports: A Time-Varying Coefficients Approach

- [Adrian Mendoza*](#) (University of the Philippines)
- Discussant: Vidya C. T.

Locating Positions in Global Production Networks: A Cross-Country Examination of Upstream, Midstream, and Downstream Dynamics and its Shock Propagations in Textiles & Clothing Sector

- [Vidya C. T.*](#) (Centre for Economic and Social Studies) and Prabheesh. K.P. (Indian Institute of Technology)
- Discussant: Sili Zhou

Unlocking Innovation: The Impact of Free Trade Zones on Corporate Innovation in China

- Ruiyang Hu (University of Macau), Chen Yin (Fudan University), Zhijie Zheng (Beijing Normal University), and [Sili Zhou*](#) (University of Macau)
- Discussant: Aiko Kikkawa

* Presenter

[<< Go back to main agenda](#)

14 July 2024, Sunday (1:15 pm–2:45 pm)
Room 107, Woosuk Economic Hall

Session 5A: Agriculture and Rural Development II

Moderator: Sujata Visaria, City, University of London

Information Provision and Risk Attitudes of Subsistence Tribal Farmers in Eastern India:
Evidence from Field Experiments

- [Raja Rajendra Timilsina*](#) (ADBI), Shibly Shahrier (Teesside University), Dil B Rahut (ADBI), Pradyot Ranjan Jena (National Institute of Technology), and Tetsushi Sonobe (ADBI)
- Discussant: Sagar Saxena

Distributional Effects of Indian Agricultural Interventions

- Shresth Garg (Harvard University) and [Sagar Saxena*](#) (Yale University)
- Discussant: Saisawat Samutpradit

Urban–Rural Migration and Agricultural Production: Evidence from Returning Family Migrants

- [Saisawat Samutpradit*](#) (Center for Research and Education in Program Evaluation, the University of Tokyo, and Center for Research and Analysis of Migration, University College London)
- Discussant: Raja Rajendra Timilsina

*Presenter

[<< Go back to main agenda](#)

14 July 2024, Sunday (1:15 pm–2:45 pm)
Room 109, Woosuk Economic Hall

Session 5B: Climate Change and Environment III

Moderator: Peter Morgan, Asian Development Bank Institute

Factors Influencing Climate Change Adaptation Among Farmers in the Mekong Delta

- Taesoo Choi (Seoul National University), Inae Kim* (Seoul National University), Hanna Jeong (Seoul National University), Suyeon Ro (Seoul National University), Oh Sang Kwon (Seoul National University), and Jongwook Lee (Seoul National University)
- Discussant: Ranjan Shrestha

Weather Shocks and Economic Well-Being in Indonesia

- Pasita Chaijaroen (Vidyasirimedhi Institute of Science and Technology), Elan Satriawan* (National Team for the Acceleration of Poverty Reduction), Ranjan Shrestha (William & Mary)*, and Sudarno Sumarto (National Team for the Acceleration of Poverty Reduction)
- Discussant: Abhinav Narayanan

Short-Run Impacts of Floods: A Case Study from India

- Robert C. M. Beyer (The World Bank and International Monetary Fund), Abhinav Narayanan* (Asian Infrastructure Investment Bank), and Gogol Mitra Thakur (Centre for Development Studies)
- Discussant: Inae Kim

*Presenter

[<< Go back to main agenda](#)

14 July 2024, Sunday (1:15 pm–2:45 pm)
Room 207, Woosuk Economic Hall

Session 5C: Gender III

Moderator: Aiko Kikkawa, Asian Development Bank

Trade and Gendered Labor Outcomes: Evidence from Changing Export Demand in Indonesia

- Donny Pasaribu (CIPS), Ridho Al Izzati (SMERU Research Institute) and [Joseph Marshan*](#) (Australian National University)
- Discussant: Ying-Min Kuo

Gender Differences in Retirement Wellbeing

- [Ying-Min Kuo*](#) (Soochow University), Ruoh-Rong Yu, Hui-Pei Cheng, and Hung-Lin Tao
- Discussant: Xiaohan Yang

Bridging the Gender Gap in Entrepreneurship and Empowering Women via Digital Technologies

- Lin William Cong (Cornell University and NBER), Jacopo Ponticelli (Northwestern University), [Xiaohan Yang*](#) (Chinese University of Hong Kong), and Xiaobo Zhang (Peking University and IFPRI)
- Discussant: Joseph Marshan

* Presenter

[<< Go back to main agenda](#)

14 July 2024, Sunday (1:15 pm–2:45 pm)
Room 208, Woosuk Economic Hall

Session 5D: Regional Cooperation and Economic Integration III

Moderator: Donghyun Park, Asian Development Bank

Global Shocks and Monetary Policy Transmission in Emerging Markets

- Nuobu Renzhi* (Capital University of Economics and Business) and John Beirne (ADB)
- Discussant: Sili Zhou

The Effect of the China Connect

- Chang Ma (Fudan University), John Rogers (Fudan University), and Sili Zhou* (University of Macau)
- Discussant: Mishael Joy S. Barrera

Do Non-Monetary Forms of Remittances Matter for Entrepreneurship Development?
Evidence from Filipino Migrants in Japan

- Mishael Joy S. Barrera* (Ritsumeikan University), Jean-Claude Maswana (Ritsumeikan University), and Kazuo Inaba (Ritsumeikan University)
- Discussant: Nuobu Renzhi

*Presenter

[<< Go back to main agenda](#)

14 July 2024, Sunday (1:15 pm–2:45 pm)
Room 307, Woosuk Economic Hall

Session 5E: Macroeconomics and Finance IV

Moderator: John Beirne, Asian Development Bank

Luminosity and Local Economic Growth

- [John Gibson*](#) (University of Waikato), Bonggeun Kim (Seoul National University), and Chow Li (University of Auckland)
- Discussant: Elis Deriantino Naiborhu

The Lending Implications of Loan Loss Provisions and Monetary Policy in Indonesia

- [Elis Deriantino Naiborhu*](#) (Bank Indonesia)
- Discussant: Juncong Guo

Learning from Neighbors: Peer Effects in Chinese Household Financial Investments

- [Juncong Guo*](#) (Shanghai Jiao Tong University) and Xi Qu (Shanghai Jiao Tong University)
- Discussant: John Gibson

* Presenter

[<< Go back to main agenda](#)

14 July 2024, Sunday (1:15 pm–2:45 pm)
Room 308, Woosuk Economic Hall

Session 5F: Labor III

Moderator: Albert Park, Asian Development Bank

The Effect of Fringe Benefit Tax on Wages: Evidence from India

- Mukta Mukherjee* (Alliance University)
- Discussant: Qisha Quarina

Expanding Workers' Social Protection Schemes for Informal Workers in Indonesia:
Between Urgency and Necessity

- Qisha Quarina* (Universitas Gadjah Mada), Akmal Shalahuddin (Universitas Gadjah Mada), Muhammad Faiz Zaidan Alharkan (Universitas Gadjah Mada), and Raniah Salsabila (Universitas Gadjah Mada)
- Discussant: Tanisa Tawichsri

The Minimum Wage Effects on Earnings and Sorting

- Suphanit Piyapromdee (University College London), Tanisa Tawichsri* (Puey Ungphakorn Institute for Economic Research), and Nada Wasi (Puey Ungphakorn Institute for Economic Research)
- Discussant: Mukta Mukherjee

* Presenter

[<< Go back to main agenda](#)

14 July 2024, Sunday (3:00 pm–4:30 pm)
Room 107, Woosuk Economic Hall

Session 6A: Climate Change, Energy, and Environment

Moderator: Yothin Jinjarak, Asian Development Bank

The Distributional Effects of Climate Change. An Empirical Analysis

- Haroon Mumtaz (Queen Mary University of London) and [Angeliki Theophilopoulou*](#) (Brunei University London)
- Discussant: Abhijit Sen Gupta

Do Power Outages Hurt Export Performance? Evidence from a Firm-Level Survey

- [Abhijit Sen Gupta*](#) (Asian Infrastructure Investment Bank) and Prakash Singh (Goa Institute of Management)
- Discussant: Qilin Huang

Domestic Pollution Havens: Linking Interregional Capital Flight and Water Pollution Regulation in China

- Kerui Du (China Institute for Studies in Energy Policy, Xiamen University), [Qilin Huang*](#) (China Institute for Studies in Energy Policy, Xiamen University), and Presley K. Wesseh, Jr. (China Institute for Studies in Energy Policy, Xiamen University)
- Discussant: Angeliki Theophilopoulou

*Presenter

[<< Go back to main agenda](#)

14 July 2024, Sunday (3:00 pm–4:30 pm)
Room 109, Woosuk Economic Hall

Session 6B: Domestic Resource Mobilization and Governance III

Moderator: Daniel Suryadarma, Asian Development Bank Institute

Politics of Transfers in Indonesia: Evidence from Regression Discontinuity Design

- [Eko Sumando*](#) (Australian National University)
- Discussant: Céline Azémar

The Effects of Tax Holidays on Investment and Innovation: A Firm-level Data Analysis in Thailand

- [Céline Azémar*](#) (Remnes School of Business) and Saowalak Boonaiem (Revenue Department of Thailand)
- Discussant: Apyogi Hardoko

The Effects of Indonesia's Country-by-Country Reporting Regulation on Investment

- [Apyogi Hardoko*](#) (The Directorate General of Taxes of Indonesia and Hitotsubashi University)
- Discussant: Eko Sumando

* Presenter

[<< Go back to main agenda](#)

14 July 2024, Sunday (3:00 pm–4:30 pm)
Room 207, Woosuk Economic Hall

Session 6C: Regional Cooperation and Economic Integration IV

Moderator: Keun Lee, Seoul National University

Navigating Global Value Chains: An Analysis of The Indonesian Electronics Industry's Impact on International Trade, Labor, and Collaborative Relationship

- Fitri Bahari* (Center for Indonesia Taxation Analysis) and Akhmad Syakir Kurnia (Diponegoro University)
- Discussant: Seonho Shin

Are Unexpected Guests Welcomed by Hosts?: Evidence on How Natives Respond to Sudden Asylum Seeker Influx

- Seonho Shin* (Ajou University)
- Discussant: Gunjan Kumari

Questioning the Quality: Reputational Impact on Indian Pharmaceutical Exports

- Gunjan Kumari* (Indian Institute of Foreign Trade), Oindrila Dey (Indian Institute of Foreign Trade) and Debashis Chakraborty (Indian Institute of Foreign Trade)
- Discussant: Fitri Bahari

*Presenter

[<< Go back to main agenda](#)

14 July 2024, Sunday (3:00 pm–4:30 pm)
Room 208, Woosuk Economic Hall

Session 6D: Poverty and Inequality II

Moderator: Yi Jiang, Asian Development Bank

Financial Literacy and Fintech Use in Family Business: Evidence from Developing Asia

- Wataru Kodama (ADBI), [Peter Morgan*](#) (ADBI), Dina Azhgaliyeva (ADBI), and Long Trinh (Ton Duc Thang University)
- Discussant: Farzana Hossain

Rainfall, Health Risks, and Socioeconomic Vulnerability in Environmentally Vulnerable Populations

- [Farzana Hossain*](#) (Centre for Health Economics, Monash University), David Johnston (Centre for Health Economics, Monash University), Rohan Sweeney (Centre for Health Economics, Monash University), Fiona Barker (Monash University), Ruzka Taruc (Revitalising Informal Settlements and their Environments Project, Indonesia), and Karin Leder (Monash University)
- Discussant: Juneyoung Lee

What “Causes” Income Inequality? Technological Innovation versus Financialization

- [Juneyoung Lee*](#) (Korea Institute for Industrial Economics and Trade) and Keun Lee (Seoul National University and CIFAR Program on Innovation, Equity, and Prosperity)
- Discussant: Peter Morgan

* Presenter

[<< Go back to main agenda](#)

14 July 2024, Sunday (3:00 pm–4:30 pm)
Room 307, Woosuk Economic Hall

Session 6E: Macroeconomics and Finance V

Moderator: Jinhee Kim, Seoul National University and Institute of Energy Research

Indonesian Household Asset Allocation Behavior

- Kartina Eka Darmawanti (Central Bank of Indonesia), Rieska Indah Astuti (Central Bank of Indonesia), Anita* (Central Bank of Indonesia), Hendro Wicaksono (Central Bank of Indonesia), Azka Aziefah Dienillah (Central Bank of Indonesia), and Moh Najikhul Fajri (Central Bank of Indonesia)
- Discussant: Longtian Zhang

A Generalized Model of Growth in the Data Economy

- Danxia Xie (Tsinghua University) and Longtian Zhang* (Central University of Finance and Economics)
- Discussant: Mary Krysllette C. Bunyi

Unpacking the Determinants of Financial Resilience in the Philippines

- Mary Krysllette C. Bunyi* (Bangko Sentral ng Pilipinas)
- Discussant: Anita

*Presenter

[<< Go back to main agenda](#)

14 July 2024, Sunday (3:00 pm–4:30 pm)
Room 308, Woosuk Economic Hall

Session 6F: Health and Gender

Moderator: Joseph Zveglich Jr., Asian Development Bank

Long-term Impacts of Growth and Development Monitoring: Evidence from Routine Health Examinations in Early Childhood

- Yinhe Liang (Central University of Finance and Economics), Xiaobo Peng (Central University of Finance and Economics), and [Meiping Aggie Sun*](#) (Fordham University)
- Discussant: Wei Luo

Shaping Gender Role Attitudes: The Influence of Parental Occupational Differences on the Next Generation

- Shu Cai (Jinan University), [Wei Luo*](#) (Jinan University), and Zheng Zhong (Jinan University)
- Discussant: Minhee Chae

Unintended Consequences of Family Planning Policies on the Breastfeeding Gap between Sons and Daughters

- [Minhee Chae*](#) (Nankai University), Yong Cai (University of North Carolina at Chapel Hill), Jun Hyung Kim (Jinan University and IZA Institute of Labor Economics), and William Lavelly (University of Washington)
- Discussant: Meiping Aggie Sun

* Presenter

[<< Go back to main agenda](#)

Internet access at conference venue (Free WiFi Service)

Visitors can use SNU Wi-Fi temporarily. SKT, KT, and LG Wi-Fi services are also available at no charge. For more information including manuals, visit the website below:
<https://ist.snu.ac.kr/en/node/95>

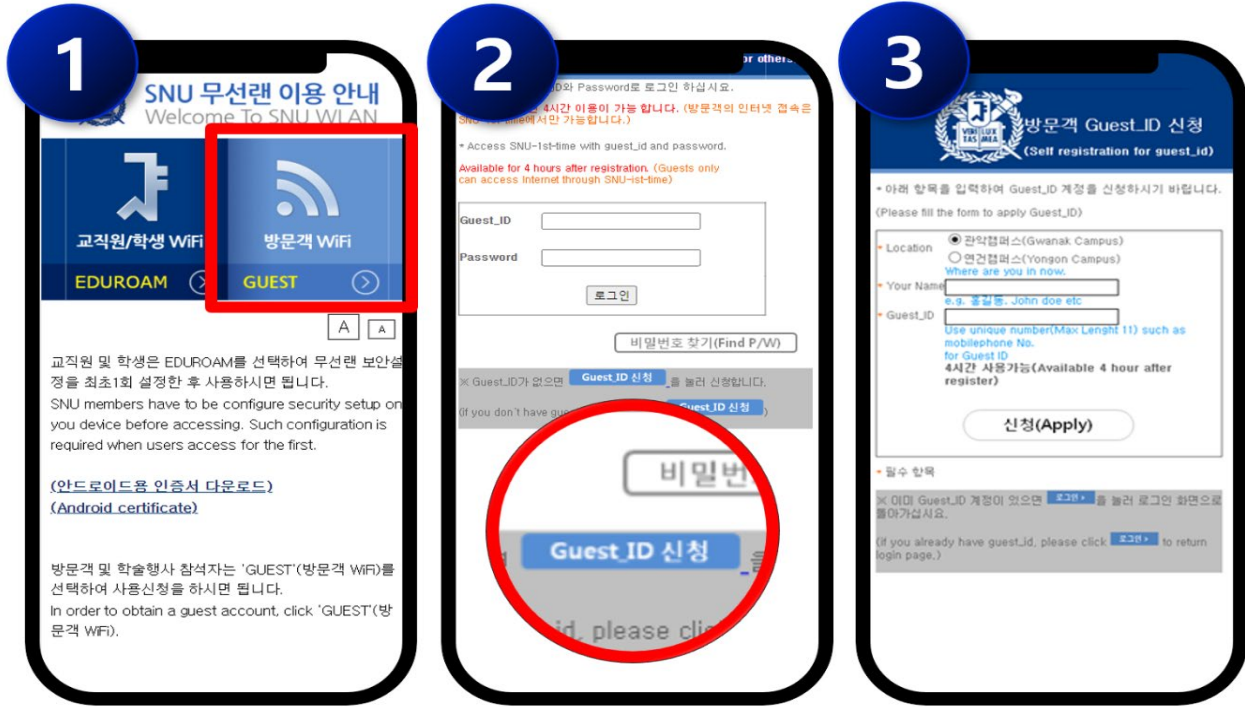

How to Access SNU_Wifi_Access_Guide

Targets of Service	How to Use
SNU community	1. Select "eduroam " from the wireless LAN service list, and login with your SNU email address (SNU_ID@snu.ac.kr) and password. - SNU Wifi access guide is available on "SNU_Wifi_Access_Guide" from the wifi service list on our campus.
Visitors	1. Select "SNU_Wifi_Access_Guide" from the wireless LAN service list. 2. Open your browser, select "GUEST" on the SNU wireless LAN service guideline page. 3. Request a temporary user ID. → Login possible immediately. ※ Time limited to 4 hours.

Transportation Guide

Public transport to Seoul National University

1) Taxi

If you want to take a taxi, here is the destination.

Location (English): Seoul National University, Building No. 223 (Woosuk Economic Hall)

Location (Korean): 서울대학교223동 (우석경제회관)

2) Airport Limousine (from Incheon airport to the conference venue, and vice versa)

Take Airport Limousine number 6003 from either Terminal 1 or 2 at Incheon International Airport. Get off at Seoul National University. This is the last stop of the bus. To return to the airport from the conference venue, walk to the campus entrance and catch Airport Limousine 6003. Get off at the terminal that corresponds to your airline: Terminal 1 or 2.

You can find more information about Airport Limousine at the below link:

https://airportlimousine.co.kr/en/sub/sub01.php?cat_no=9

3) Subway

From Seoul Station: Get on subway Line number 1 ▶ Get off at Daebang Station ▶ Get on the Sillim Line (at the Daebang Station) ▶ Get off at Gwanaksan Station ▶ Walk to the main gate of Seoul National University

Below is a map from Gwanaksan Station to the main gate



4) Bus

From Seoul Station to Seoul National University ▶ Walk to Seoul Station bus Transfer Center ▶ Take bus number 750A or 750B ▶ Travel to Seoul National University

a. Take either 750A or 750B at the Seoul Station Bus Transfer Center located on the left side of exit number 9-1 at Seoul Station

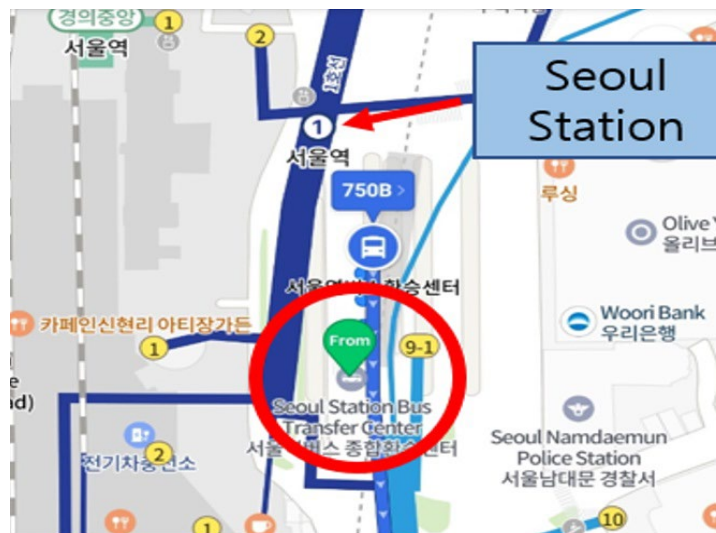

b. Get off at Seoul National University and walk to the main gate (takes less than 1 min)

